

**\*NOTE:**  
 1. ALL DIMENSIONS SHALL BE VERIFIED AND CHECKED BEFORE THE EXECUTION ON SITE.  
 2. THERE WILL BE NECESSARY CHANGES IN THE PROPOSED PLANS DUE TO THE ACTUAL SITE CONDITIONS. CONTRACTORS/PERSONS IN-CHARGE AT SITE SHALL COORDINATE FIRST THE SHOP DRAWINGS FOR THE APPROVAL OF THE ARCHITECT/ENGINEER PRIOR TO IMPLEMENTATION.

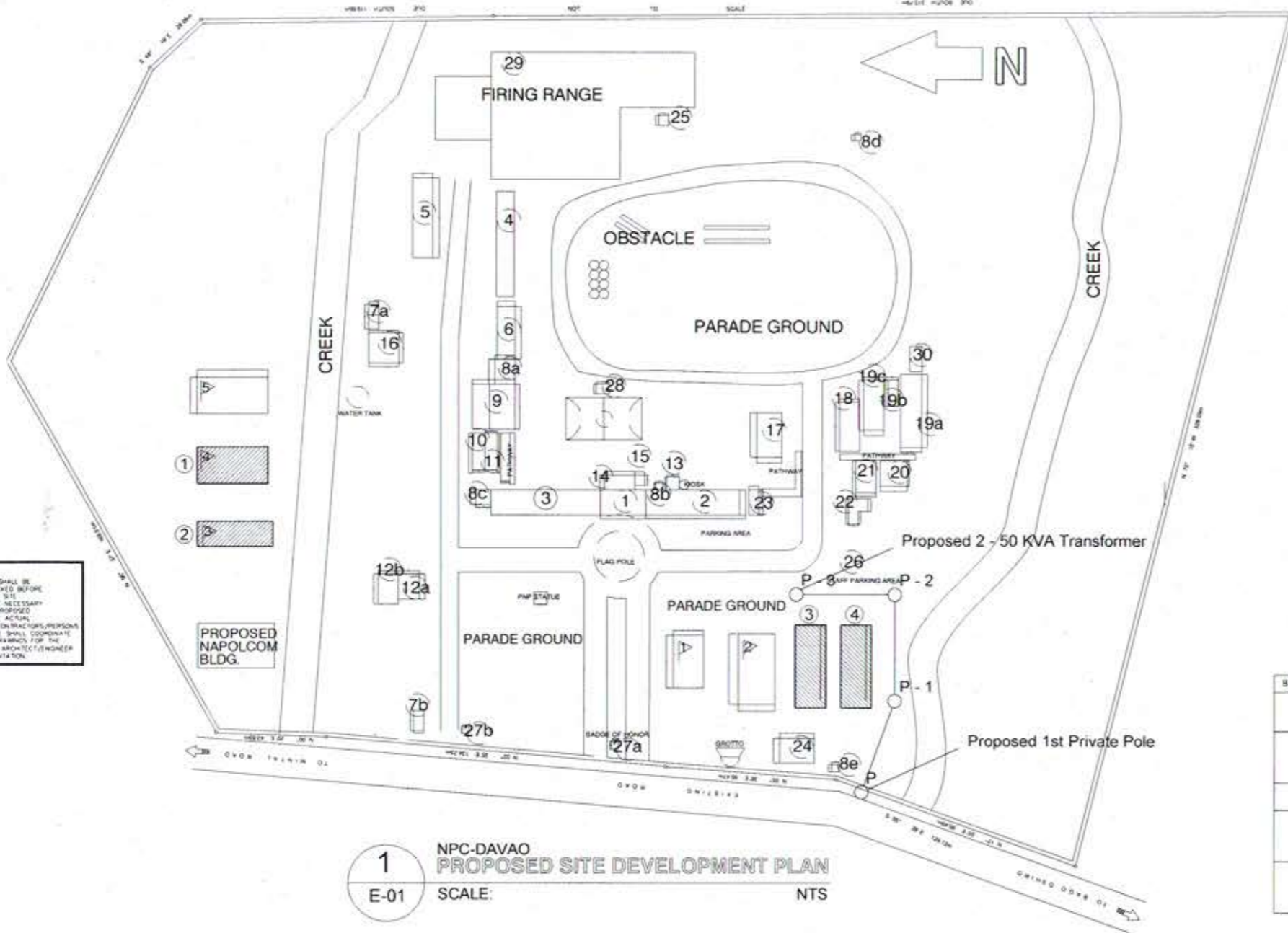

| BLDG # | DESCRIPTION                           | AREA (SQ. M) |
|--------|---------------------------------------|--------------|
| 1      | TWO STOREY ADMINISTRATION BUILDING    | 356.96       |
| 2      | TWO CLASSROOM (RIGHT WING)            | 392.82       |
| 3      | TWO CLASSROOM (LEFT WING)             | 430.6        |
| 4      | CAMPOS DORMITORY (A, CENTER, B)       | 294          |
| 5      | SANTOLAN DORMITORY                    | 256          |
| 6      | ROY ROY 2 DORMITORY                   | 147          |
| 7      | A. STAFF QUARTER (WHITE HOUSE)        | 40.57        |
|        | B. STAFF QUARTER (JAGUAR) NEAR GATE   | 32.55        |
| 8      | A. COMFORT ROOM                       | 80           |
|        | B. INSTRUCTOR'S COMFORT ROOM          | 7.84         |
|        | C. COMFORT ROOM (ADMIN BUILDING)      | 24           |
|        | D. COMFORT ROOM (OVAL)                | 6.25         |
|        | E. COMFORT ROOM ROOM BESIDE CHAPEL    | 9            |
| 9      | CARILLO DORMITORY                     | 106          |
| 10     | RON RON DORMITORY                     | 96.72        |
| 11     | ROY ROY 1 DORMITORY                   | 96.72        |
| 12     | A. RTD'S QUARTER                      | 84           |
|        | B. RTD'S QUARTER ANNEX                | 95           |
| 13     | INSTRUCTOR'S LOUNGE                   | 25           |
| 14     | CANTEEN                               | 72           |
| 15     | MEDICAL ROOM (CLINIC)                 | 16           |
| 16     | STOCKROOM (FORMERLY DORMITORY)        | 144          |
| 17     | PATNUBAY HALL (CLASSROOM & EXTENSION) | 178          |
| 18     | TEVES DORMITORY                       | 158          |
| 19     | A. MESSHALL 1 (OUTMOST)               | 249.05       |
|        | B. MESSHALL 2 (CENTER)                | 52.5         |
|        | C. MESSHALL 3 (INNERMOST)             | 160          |
| 20     | OSEC CLASSROOM                        | 107.64       |
| 21     | MATURAN DORMITORY                     | 114.24       |
| 22     | SENDO DORMITORY                       | 78           |
| 23     | E-LIBRARY                             | 40           |
| 24     | CHAPEL                                | 136          |
| 25     | RAPELLING TOWER                       | 16           |
| 26     | STAFF PARKING AREA                    | N/A          |
| 27     | A. GUARD POST (GATE)                  | 8            |
|        | B. GUARD POST (SIDE)                  | 4            |
| 28     | STAGE (OUTDOOR)                       | 20           |
| 29     | FIRING RANGE                          | N/A          |
| 30     | KITCHEN                               | 50           |

| BLDG # | DESCRIPTION   | YEAR | SQ.M |
|--------|---|------|------|
| 1      | PROPOSED TWO (2) STOREY FOUR (4) UNIT CLASSROOM NPC                   | 2018 | 252  |
| 2      | PROPOSED TWO (2) STOREY 200 CAPACITY DORMITORY W/ ROOFDECK NPC        | 2019 | 406  |
| 3      | PROPOSED FOUR (4) STOREY NIMPTI BUILDING                              | 2019 | 300  |
| 4      | PROPOSED THREE (3) STOREY 300 CAPACITY DORMITORY 2 W/ ROOFDECK NPTI   | 2020 | 406  |
| 5      | PROPOSED THREE (3) STOREY 300 CAPACITY DORMITORY 2 W/ ROOFDECK NIMPTI | 2020 | 406  |

**1** NPC-DAVAO  
**E-01** PROPOSED SITE DEVELOPMENT PLAN  
 SCALE: NTS

|   |  |  |  |  |  |   |  |  |  |   |  |   |  |   |  |  |  |   |  |
|---|--|--|--|--|--|---|--|--|--|---|--|---|--|---|--|--|--|---|--|
| <br>ENGR. JESSE R. MANAYAN<br>Electrical Engineer |  | RA 5206 ART IV Sec. 33<br>Ownership of Plans, Specifications and Other Contract Documents: Ownership and specifications and other contract documents shall remain the property of the Architect. |  | <br>ENGR. RICHE S. VERA<br>Electrical Engineer |  | PROJECT TITLE:<br><b>SEPARATION OF ELECTRICAL POST, ELECTRICAL LINES AND TRANSFORMER (2-50KVA) AT NPC-DAVAO</b> |  | PROJECT OWNER:<br><br><b>PHILIPPINE PUBLIC SAFETY COLLEGE</b><br>DEPARTMENT OF POLICE AND LOCAL GOVERNMENT |  | RECOMMENDING SUBMISSION:<br>ALEX R. REYES, MPA<br>D/C, General Services Section |  | SUBMITTED BY:<br><br>ALEX R. REYES, MPA<br>Chief Administrative Officer |  | RECOMMENDING APPROVAL:<br><br>PROFRON FERNANDO SEVILLA<br>Vice President for Administration |  | APPROVED BY:<br><br>PLT. COL. NESTOR DE LEON, P. O. (Ret.)<br>Director of Philippine Public Safety College |  | SHEET CONTENTS:<br>SHEET NAME:<br><b>E-01</b><br>SHEET NO:<br><b>01 OF 01</b> |  |
|---|--|--|--|--|--|---|--|--|--|---|--|---|--|---|--|--|--|---|--|